

REVISIONS					
REV. SYM.	E.C.O. NUMBER	DESCRIPTION	BY DATE	APP'D DATE	
1		ORIGINAL RELEASE	JWJ 5/1/00	RRR 5/1/00	

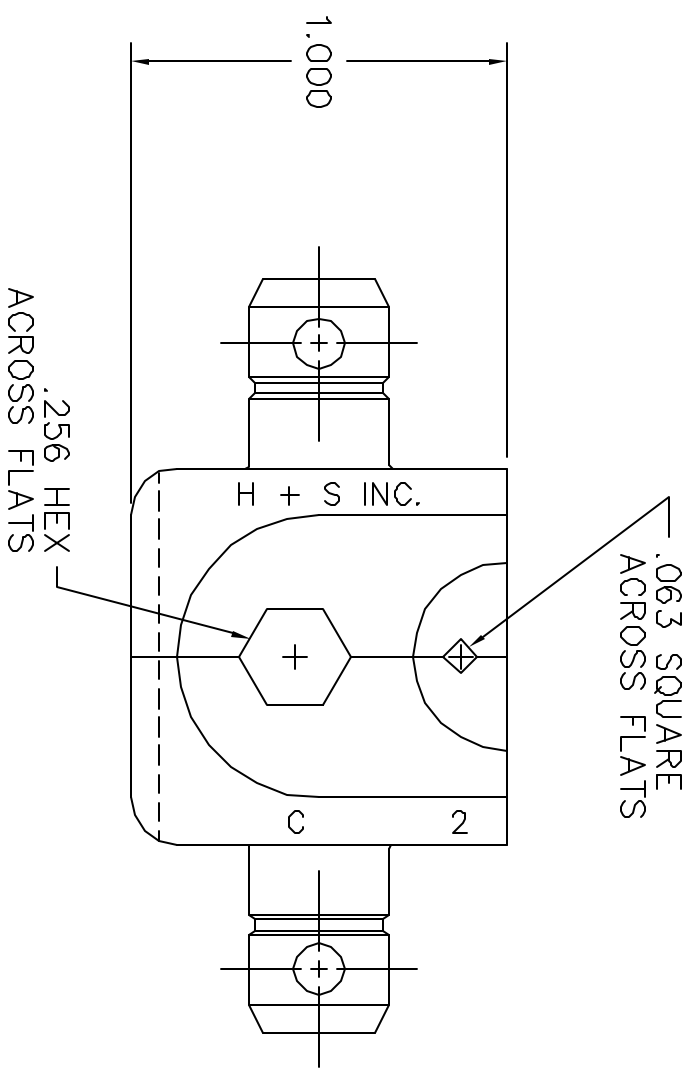
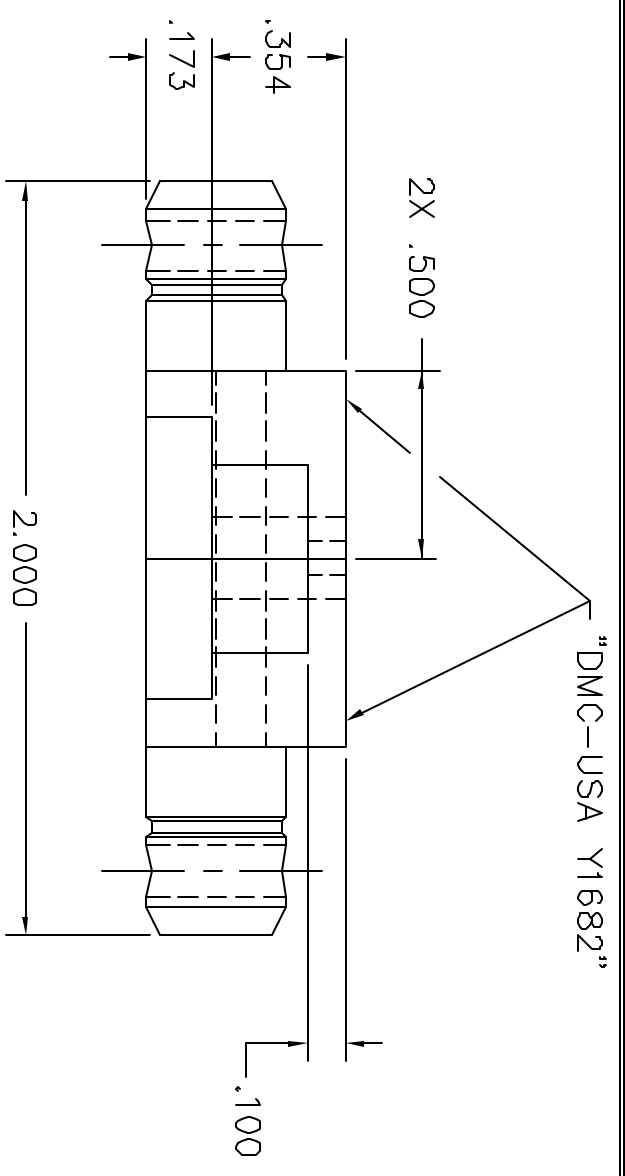

**UNCONTROLLED DOCUMENT  
WILL NOT BE UPDATED**

1. REF: HUBER + SUHNER DIE SET NO. 90046303.

NOTES:

<p>RESTRICTED &amp; CONFIDENTIAL CONFIDENTIAL PROPERTY OF DANIELS MANUFACTURING CORP. NOT TO BE DISCLOSED TO OTHERS, REPRODUCED OR USED FOR ANY OTHER PURPOSE, EXCEPT AS AUTHORIZED IN WRITING BY DANIELS MANUFACTURING. MUST BE RETURNED TO DANIELS MANUFACTURING CORP. ON COMPLETION OF ORDER OR OTHER PURPOSE FOR WHICH LENT.</p>		<p>MATERIAL HEAT TREAT FINISH</p>		<p>DO NOT SCALE DRAWING</p>	
<p>ITEM DRN. J. JOYCE CHKD. RRR APP'D. APP'D.</p>	<p>PART NO. DATE 5/1/00 DATE 5/1/00 DATE</p>	<p>QTY.</p>	<p>DESCRIPTION/REMARKS DANIELS MANUFACTURING CORP. ORLANDO, FLORIDA CAGE 11851</p>	<p>WHERE USED: SIZE B SCALE 2X POSTING</p>	<p>CAD P/N Y1682-ENV SHEET 1 OF 1 REV. 1</p>
<p>NOTE: THIS DRAWING IS AN OUTLINE DRAWING OF THE RESPECTIVE DMC PART NUMBER INDICATED. ACTUAL DMC PART NUMBER IS DRAWING NUMBER WITHOUT THE "-ENV" SUFFIX.</p>					
<p>TITLE: DIE SET ENVELOPE DRAWING</p>					