

REVISIONS		BY	APPROVED
REV.	DESCRIPTION	DATE	DATE
1	ORIGINAL RELEASE	10/2/06	10/4/06

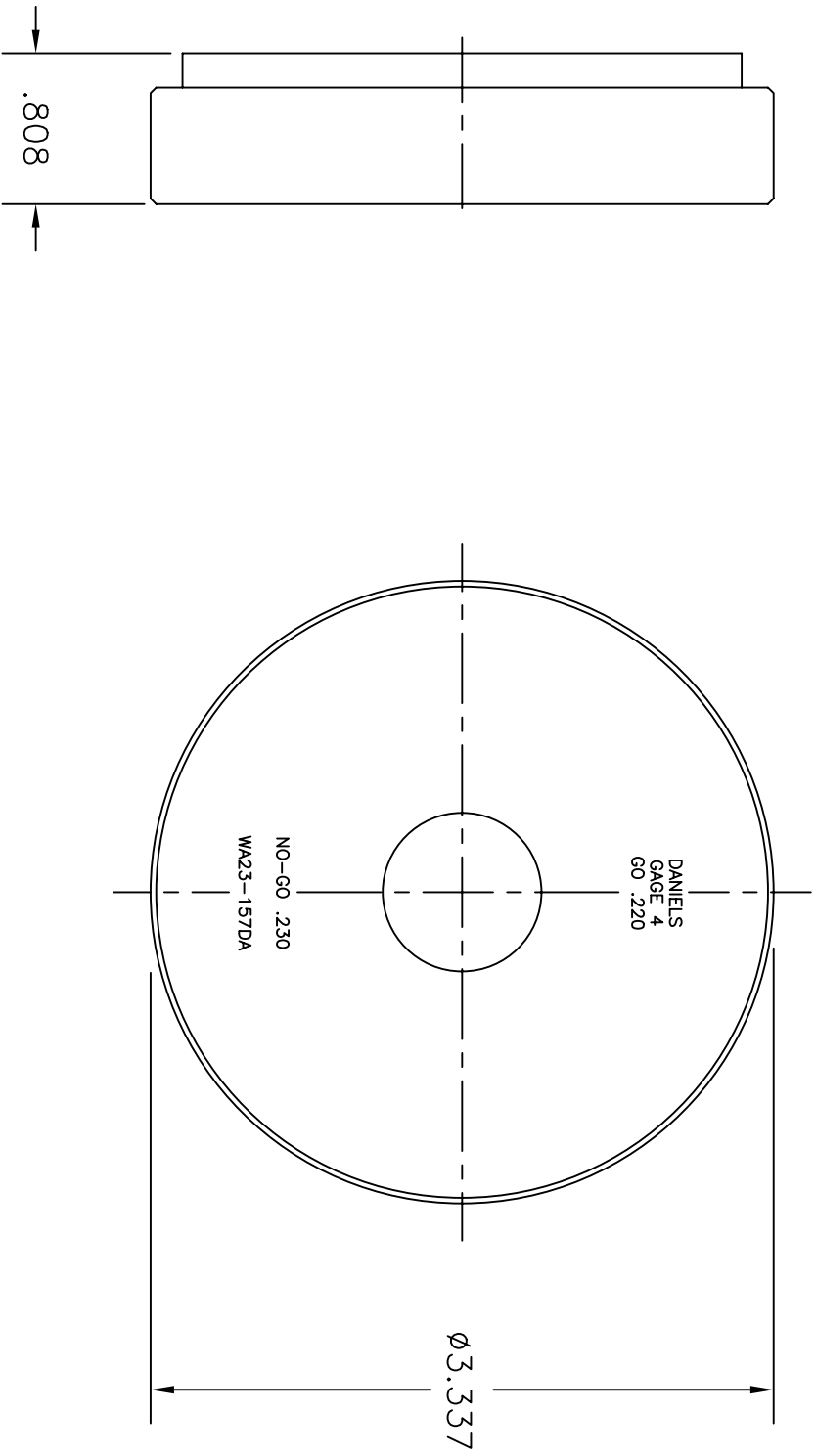

**UNCONTROLLED DOCUMENT
WILL NOT BE UPDATED**

RESTRICTED & CONFIDENTIAL CONFIDENTIAL PROPERTY OF DANIELS MANUFACTURING CORP. NOT TO BE REPRODUCED OR USED FOR ANY OTHER PURPOSE WITHOUT THE WRITTEN PERMISSION OF DANIELS MANUFACTURING CORP. ALL RIGHTS RESERVED. THIS DRAWING IS THE PROPERTY OF DANIELS MANUFACTURING CORP. IT IS TO BE USED ONLY FOR THE PURPOSES SPECIFIED IN THE ORDER OR OTHER PURPOSE FOR WHICH LEFT.		MATERIAL	HEAT TREAT		FINISH	
		ITEM	PART NO.	QTY.	DESCRIPTION/REMARKS	
DRN. J. JOYCE	10/1/06		DANIELS MANUFACTURING CORP. ORLANDO, FLORIDA ONE 1181			
CHKD. RRR	10/1/06					
APPR.	DATE					
NOTE: THIS DRAWING IS AN OUTLINE DRAWING OF THE RESPECTIVE PART NUMBER IS DRAWING THE "AS SHOWN" SPEC.						
WHERE USED:	SCALE:	SIZE:	SHEET OF			
WA23-157DA-ENV	NTS	C	1 OF 1			
DRW. NO. WA23-157DA-ENV			REV. 1			

DO NOT SCALE DRAWING