

FOR 12 GAGE WIRE, USE WITH WA23-168DA DIE ASSEMBLY.  
FOR 14 GAGE WIRE, USE WITH WA23-169DA DIE ASSEMBLY.

# WA23-115L-ENV

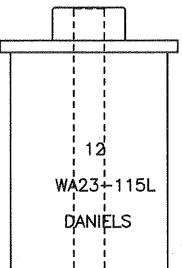
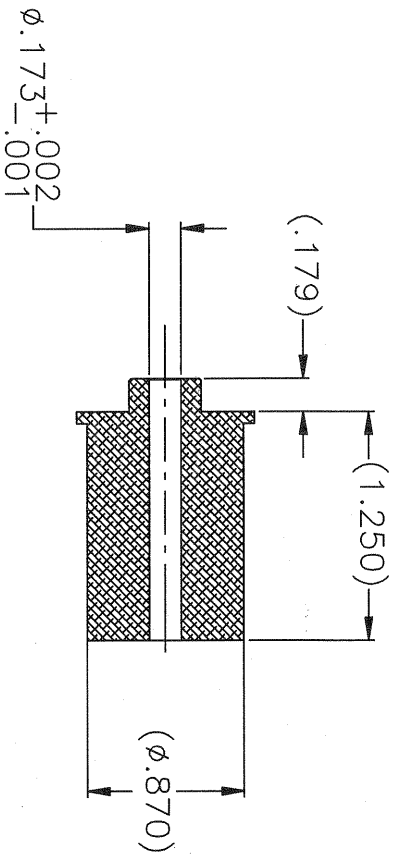
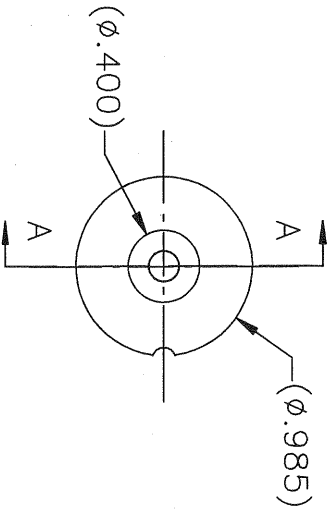

2. MAT'L: REF. 2024 ALUM.  
NOTES: 1. THIS IS AN AUTOCAD DRAWING, DO NOT CHANGE MANUALLY.

THESE DRAWINGS, SPECIFICATIONS OR OTHER DATA ARE AND REMAIN, THE PROPERTY OF ASTRO TOOL CORP. AND MUST BE RETURNED UPON REQUEST. THEY CONTAIN INFORMATION OWNED AND/OR DEVELOPED BY ASTRO AT ITS OWN PRIVATE EXPENSE AND MAY NOT BE USED, DUPLICATED OR DISCLOSED TO OTHERS, IN WHOLE OR IN PART FOR DESIGN, MANUFACTURE OR PROCUREMENT WITHOUT THE WRITTEN PERMISSION OF ASTRO TOOL CORP. EACH AND EVERY TIME.				SCALE: N.T.S.		UNLESS OTHERWISE SPECIFIED: DECIMALS: .XXX ± .005 .XX ± .010 .X ± .030 ANGLES: ± 1°		CAGE 58164	
REV.	DESCRIPTION	BY	DATE	APR.	DWN BY:	DATE:	APPROVED:	ASTRO TOOL CORP.	
A	NEW RELEASE.	DYO	02-02-12	MMK	DYO	02-02-12		21615 S.W. TUALATIN VALLEY HWY., BEAVERTON OR 97006	
								ENVELOPE DRAWING: WA23-115L	
								LOCATOR, 12 GAGE	
								PART NO. A WA23-115L-ENV	