

E.C.O. NUMBER		DESCRIPTION		BY DATE	APP'D DATE
1		ORIGINAL RELEASE		K. KOONS 2.29.08	D. EBY 2.29.08

REVISIONS

T:\Envelope\WA23-104L-ENV.dwg, 2/29/2008 1:48:48 PM Kirk C Koons, Engineer

**UNCONTROLLED DOCUMENT
WILL NOT BE UPDATED**

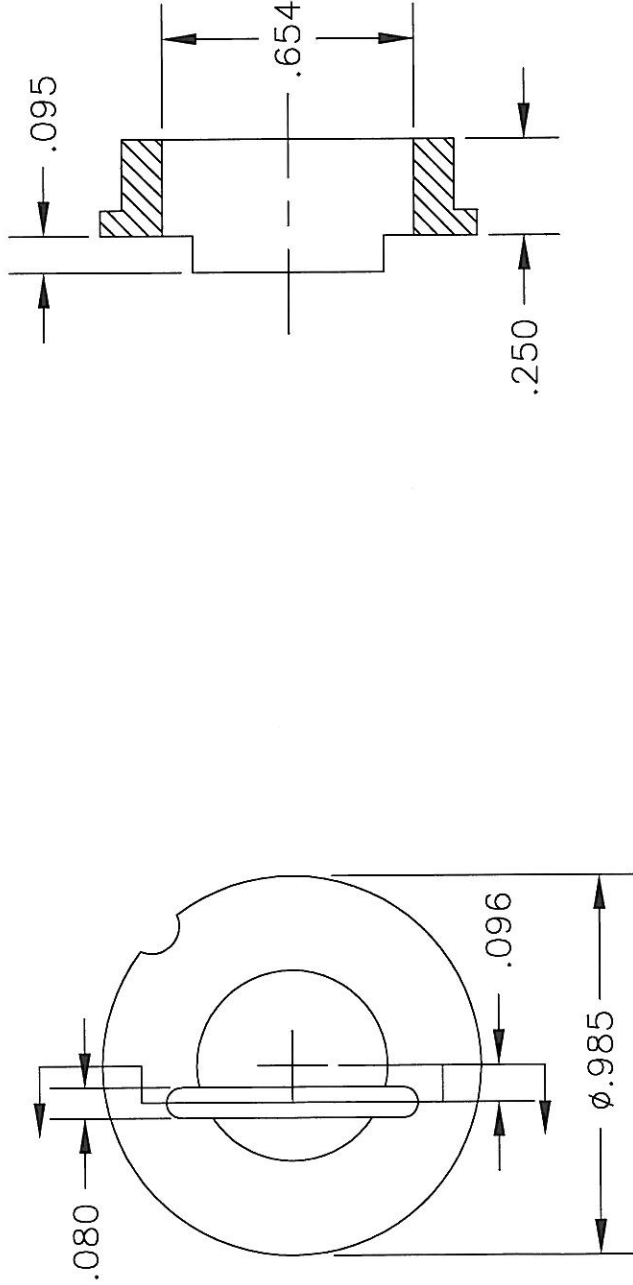

RESTRICTED & CONFIDENTIAL CONFIDENTIAL PROPERTY OF DANIELS MANUFACTURING CORP. NOT TO BE DISCLOSED TO OTHERS, REPRODUCED OR USED FOR ANY OTHER PURPOSE, EXCEPT AS AUTHORIZED IN WRITING BY DANIELS MANUFACTURING. MUST BE RETURNED TO DANIELS MANUFACTURING CORP. ON COMPLETION OF ORDER OR OTHER PURPOSE FOR WHICH LENT.		MATERIAL		ITEM		PART NO.		QTY.		DESCRIPTION/REMARKS	
DO NOT SCALE DRAWING		HEAT TREAT		DRN: K. KOONS	DATE	DATE		DATE		DANIELS MANUFACTURING CORP. ORLANDO, FLORIDA CAGE 11851	
		FINISH		CHK'D: D. EBY	DATE	DATE		DATE		TITLE	
		FINISH		APP'D:	DATE	DATE		DATE		LOCATOR ENVELOPE DRAWING	
NOTE: THIS DRAWING IS AN OUTLINE DRAWING OF THE RESPECTIVE DMC PART NUMBER INDICATED. ACTUAL DMC PART NUMBER IS DRAWING NUMBER WITHOUT THE "-ENV" SUFFIX.		WHERE USED:		SIZE		SCALE		CAD P/N		SHEET OF	
				A		NTS		WA23-104L-ENV		1 1	
				POSTING				DWG. NO.		REV.	
								WA23-104L-ENV		1	