

| REV. | E.C.O. | DESCRIPTION      | BY       | APP'D    |
|------|--------|------------------|----------|----------|
| DATE | NUMBER |                  | DATE     | DATE     |
| 1    |        | ORIGINAL RELEASE | 10/29/03 | 10/29/03 |

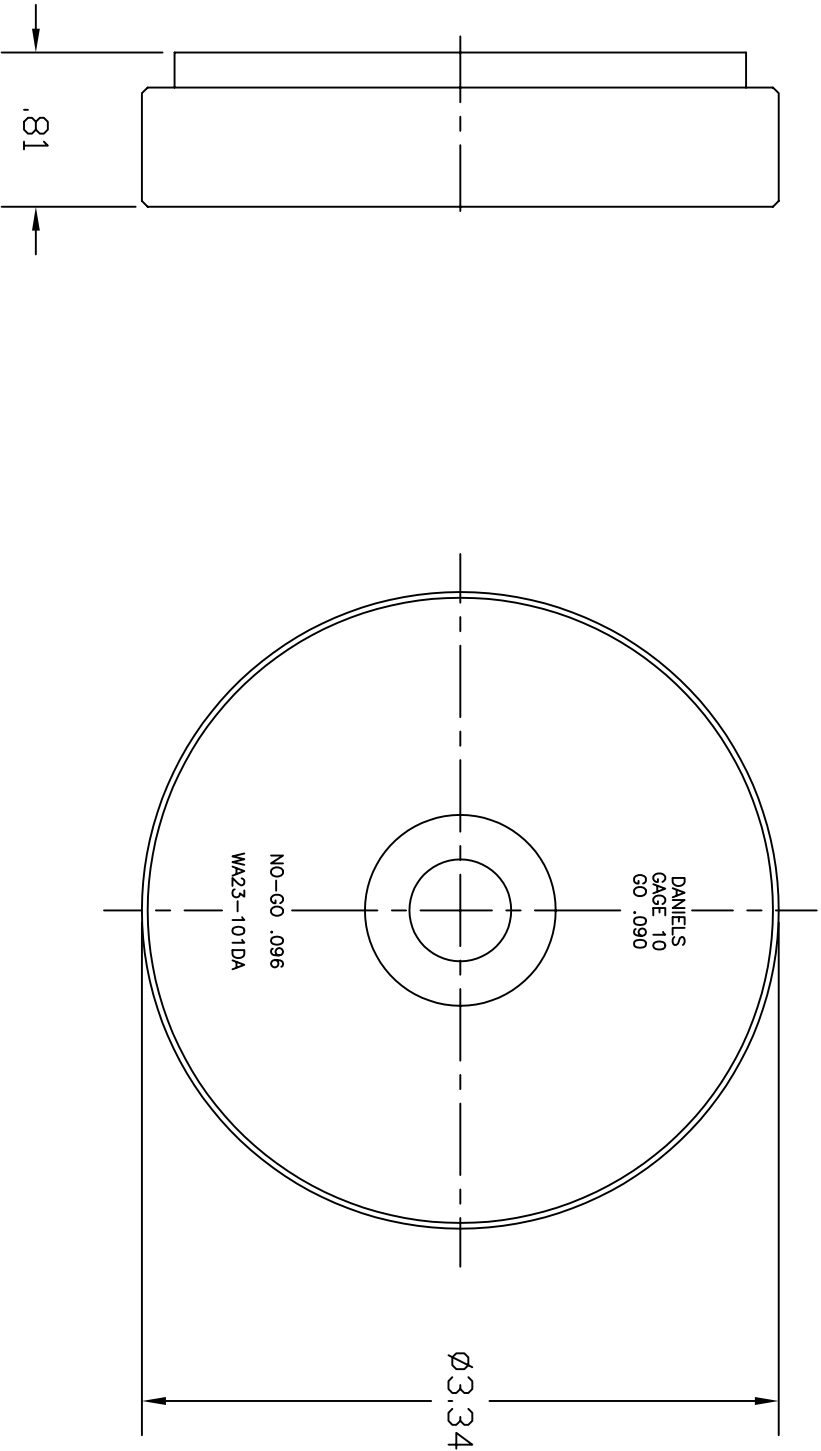

UNCONTROLLED DOCUMENT  
 WILL NOT BE UPDATED

| RESTRICTED & CONFIDENTIAL   |  | MATERIAL             |  | ITEM  |  | PART NO.                            |  | QTY.  |  | DESCRIPTION/REMARKS                   |  |
|---|--|----------------------|--|---|--|-------------------------------------|--|---|--|---------------------------------------|--|
| CONFIDENTIAL PROPERTY OF DANIELS MANUFACTURING CORP. NOT TO BE REPRODUCED OR USED FOR ANY OTHER PURPOSE BY DANIELS MANUFACTURING. MUST BE RETURNED TO DANIELS ON ORDER OR OTHER PURPOSE FOR WHICH Lent. |  |                      |  | DWN. J. JOYCE<br>CHK'D. HRR<br>APP'D. DATE  |  | DATE<br>DATE                        |  | <b>DMC</b><br>DANIELS MANUFACTURING CORP.<br>OPAWAUG, FLORIDA<br>ONE 1181 |  | DIE ASSY. SIZE 10<br>ENVELOPE DRAWING |  |
| DO NOT SCALE DRAWING  |  | FINISH<br>HEAT TREAT |  | THIS DRAWING IS THE PROPERTY OF DANIELS MANUFACTURING CORP. ALL RIGHTS RESERVED. NO PARTS OR EQUIPMENT TO BE REPRODUCED OR USED FOR ANY OTHER PURPOSE WITHOUT THE WRITTEN PERMISSION OF DANIELS MANUFACTURING CORP. |  | WHERE USED:<br>C NTS WA23-101DA-ENV |  | CAD P/N<br>DWN. NO. WA23-101DA-ENV  |  | SHEET OF 1<br>REV. 1                  |  |