

| REVISIONS | | | | |
|-----------|---------------|------------------|--------------|--------------|
| REV. SYM. | E.C.D. NUMBER | DESCRIPTION | BY DATE | APP'D DATE |
| 1 | | ORIGINAL RELEASE | AAM 11-21-02 | RRR 11-21-02 |

**UNCONTROLLED DOCUMENT
WILL NOT BE UPDATED**

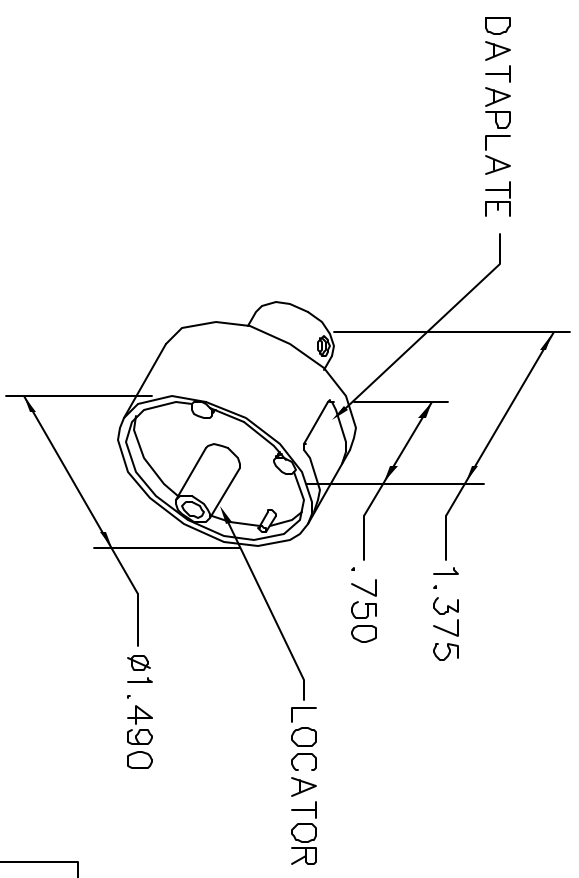

| | | | |
|----------------|----|----|-----------------|
| VIRGINIA PANEL | 16 | 14 | WIRE SIZE |
| 610 110 129 | 6 | 6 | SELECTOR NUMBER |

DATAPLATE

| | |
|-----------------|---------------------|
| LOCATOR | |
| HOLE DIMENSIONS | ADDITIONAL FEATURES |
| ø.057 ▽.974 | L □ ø.125 ▽.67 |

RESTRICTED & CONFIDENTIAL

CONFIDENTIAL PROPERTY OF DANIELS MANUFACTURING CORP. NOT TO BE DISCLOSED TO OTHERS, REPRODUCED OR USED FOR ANY OTHER PURPOSE, EXCEPT AS AUTHORIZED IN WRITING BY DANIELS MANUFACTURING. MUST BE RETURNED TO DANIELS MANUFACTURING CORP. ON COMPLETION OF ORDER OR OTHER PURPOSE FOR WHICH LENT.

DO NOT SCALE DRAWING

| | |
|-------------------|---------------|
| DRN. A. MOO-YOUNG | DATE 11-21-02 |
| CHKD. RRR | DATE 11-21-02 |
| APP'D. | DATE |
| APP'D. | DATE |

DANIELS MANUFACTURING CORP.
ORLANDO, FLORIDA
CAGE 11851

TITLE
**ENVELOPE DRAWING
SINGLE POSITION HEAD**

WHERE USED: AFB

| | | | |
|---------|-----------|--------------------|--------------|
| SIZE A | SCALE NTS | CAD P/N TP1473-ENV | SHEET 1 OF 1 |
| POSTING | | DWG NO. TP1473-ENV | REV. 1 |