

REVISIONS				
REV. SYM.	E.C.O. NUMBER	DESCRIPTION	BY DATE	APP'D DATE
1		ORIGINAL RELEASE	JWJ 10/29/03	RRR 10/29/03

**UNCONTROLLED DOCUMENT
WILL NOT BE UPDATED**

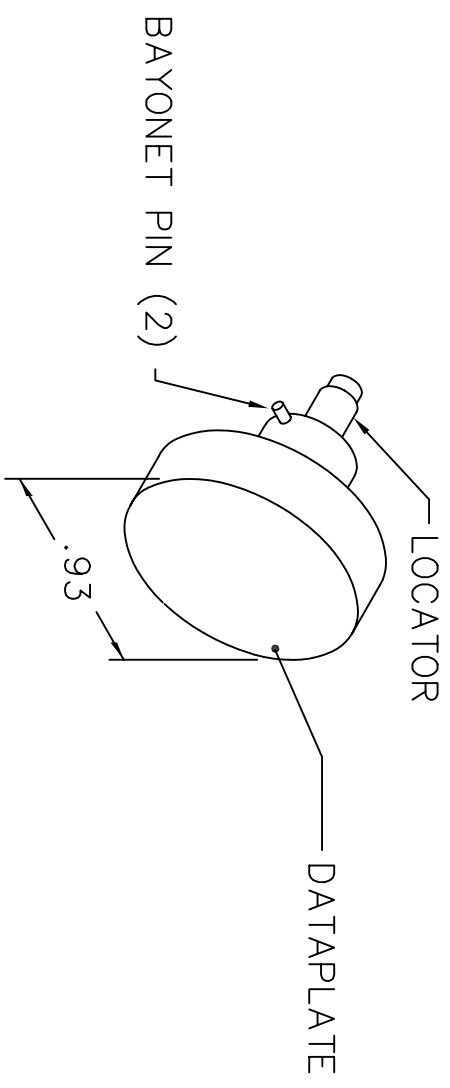
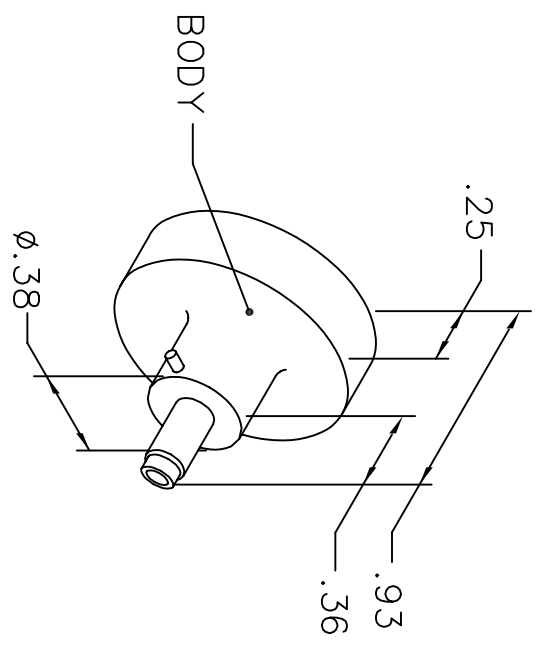

DSM DEUTSCH			
WIRE	22	24	26
SEL.	4	3	3
2202-16-0101 PIN			
WIRE	26	28	30
SEL.	3	2	2
2203-8-0101 PIN STK			

NOTE: FOR USE WITH DANIELS CRIMP TOOL AFM8.

LOCATOR	
HOLE DIMENSIONS	ADDITIONAL FEATURES
Ø.060 ±.290	

RESTRICTED & CONFIDENTIAL

CONFIDENTIAL PROPERTY OF DANIELS MANUFACTURING CORP. NOT TO BE DISCLOSED TO OTHERS, REPRODUCED OR USED FOR ANY OTHER PURPOSE, EXCEPT AS AUTHORIZED IN WRITING BY DANIELS MANUFACTURING. MUST BE RETURNED TO DANIELS MANUFACTURING CORP. ON COMPLETION OF ORDER OR OTHER PURPOSE FOR WHICH LENT.

DO NOT SCALE DRAWING

DRN. J. JOYCE	DATE 10/29/03	TITLE	
CHK'D. RRR	DATE 10/29/03	ENVELOPE DRAWING POSITIONER	
APP'D.	DATE	WHERE USED: AFM8	
APP'D.	DATE	SIZE A	SCALE NTS
NOTE: THIS DRAWING IS AN OUTLINE DRAWING OF THE RESPECTIVE DMC PART NUMBER INDICATED. ACTUAL DMC PART NUMBER IS DRAWING NUMBER WITHOUT THE "-ENV" SUFFIX.		CAD P/N K4-ENV	SHEET 1 OF 1
		DWG. NO. K4-ENV	REV. 1
		DANIELS MANUFACTURING CORP. ORLANDO, FLORIDA CAGE 11851	