

REVISIONS				
REV. SYM.	E.C.O. NUMBER	DESCRIPTION	BY DATE	APP'D DATE
1		ORIGINAL RELEASE	AAJWM 4/5/07	RRR 4/5/07

UNCONTROLLED DOCUMENT  
WILL NOT BE UPDATED

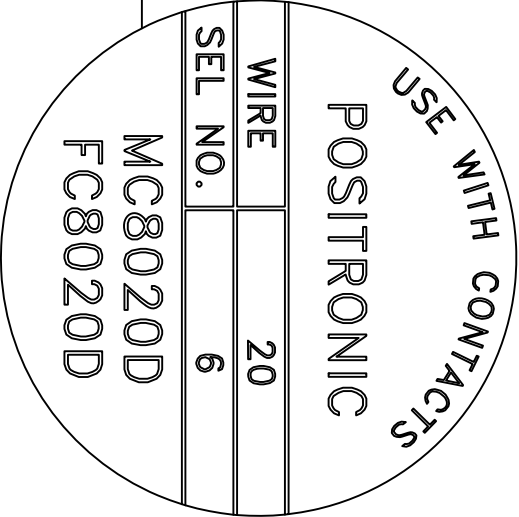
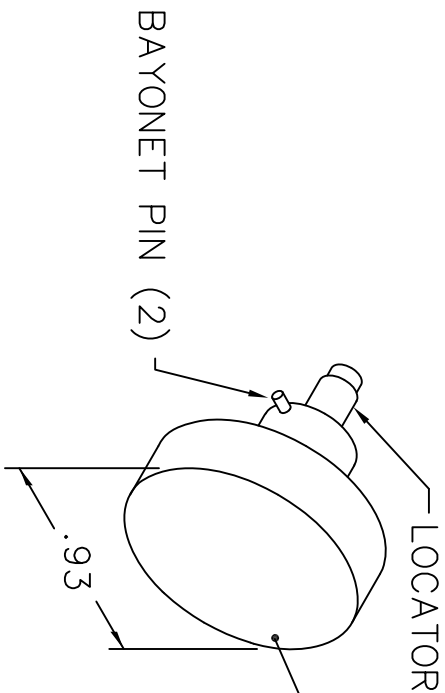
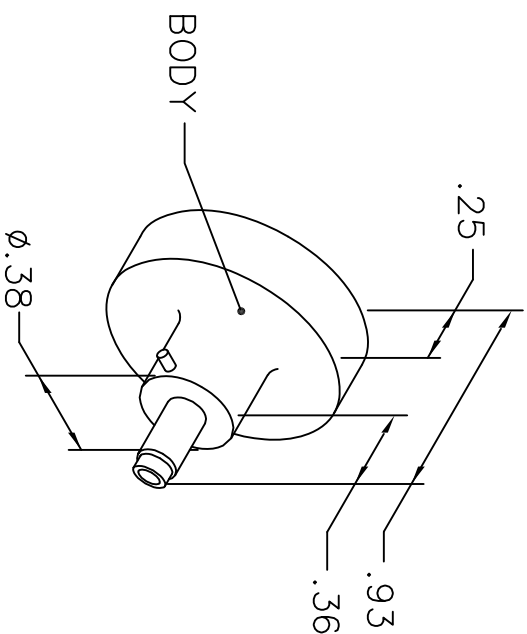

NOTE: FOR USE WITH DANIELS CRIMP TOOLS  
ACCOMMODATING "K" SERIES POSITIONERS

LOCATOR	
HOLE DIMENSIONS	ADDITIONAL FEATURES
$\phi .035$ $\nabla .739$	$\perp \phi .071$ $\nabla .727$

RESTRICTED & CONFIDENTIAL

CONFIDENTIAL PROPERTY OF DANIELS MANUFACTURING CORP. NOT TO BE DISCLOSED TO OTHERS, REPRODUCED OR USED FOR ANY OTHER PURPOSE, EXCEPT AS AUTHORIZED IN WRITING BY DANIELS MANUFACTURING. MUST BE RETURNED TO DANIELS MANUFACTURING CORP. ON COMPLETION OF ORDER OR OTHER PURPOSE FOR WHICH LENT.

DO NOT SCALE DRAWING

DRN. J. JOYCE 4/5/07

CHKD. RRR 4/5/07

APPD. DATE

APPD. DATE

NOTE: THIS DRAWING IS AN OUTLINE DRAWING OF THE RESPECTIVE DMC PART NUMBER INDICATED. ACTUAL DMC PART NUMBER IS DRAWING NUMBER WITHOUT THE "-ENV" SUFFIX.

WHERE USED: AFM8

SIZE SCALE

POSTING

DMC DANIELS MANUFACTURING CORP. ORLANDO, FLORIDA CAGE 11851

ENVELOPE DRAWING POSITIONER

CAD P/N K1665-ENV

DWG NO. K1665-ENV

SHEET 1 OF 1

REV. 1