

REVISIONS				
REV. SYM.	E.C.O. NUMBER	DESCRIPTION	BY DATE	APP'D DATE
2		SEL. 2 WAS SEL. 1	AAM 11-26-01	RRR 11-26-01

**UNCONTROLLED DOCUMENT
WILL NOT BE UPDATED**

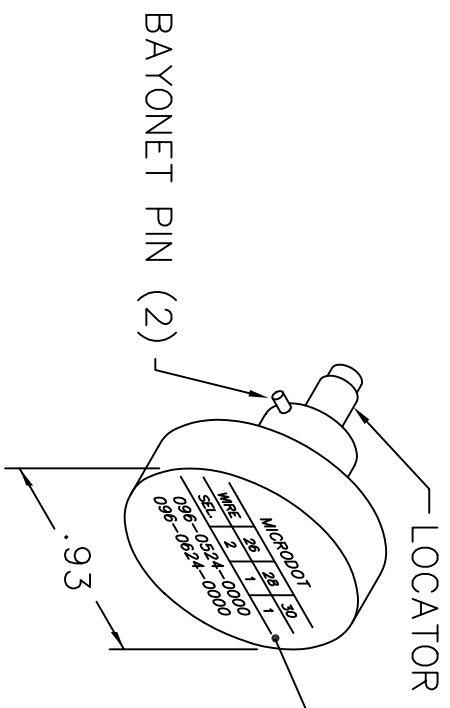
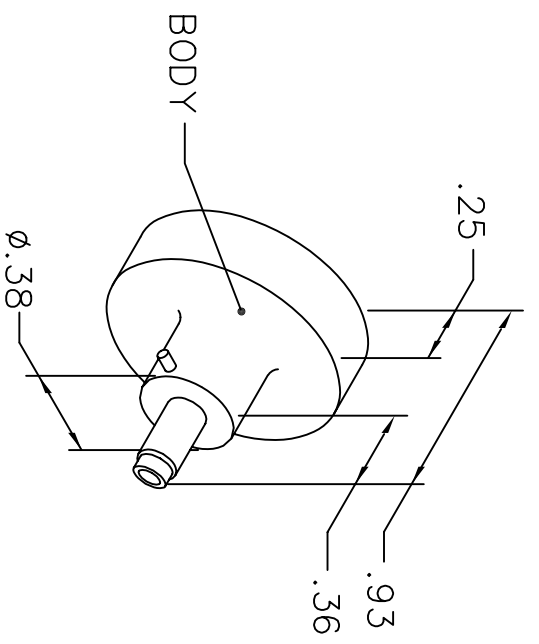

MICRODOT			
WIRE	26	28	30
SEL.	2	1	1
096-0524-0000			
096-0624-0000			

NOTE: FOR USE WITH DANIELS CRIMP TOOLS
ACCOMMODATING "K" SERIES POSITIONERS

LOCATOR	ADDITIONAL FEATURES
HOLE DIMENSIONS	$\perp \phi .021$
	$\perp .165$
	$\perp \phi .039$
	$\perp .153$

RESTRICTED & CONFIDENTIAL

CONFIDENTIAL PROPERTY OF DANIELS MANUFACTURING CORP. NOT TO BE DISCLOSED TO OTHERS, REPRODUCED OR USED FOR ANY OTHER PURPOSE, EXCEPT AS AUTHORIZED IN WRITING BY DANIELS MANUFACTURING. MUST BE RETURNED TO DANIELS MANUFACTURING CORP. ON COMPLETION OF ORDER OR OTHER PURPOSE FOR WHICH LENT.

DO NOT SCALE DRAWING

DRN. B. CAPERS	DATE 3-12-97	TITLE	
CHK'D. DP	DATE 3-12-97	ENVELOPE DRAWING POSITIONER	
APP'D.	DATE	WHERE USED: AFM8	
APP'D.	DATE	SIZE A	SCALE NTS
NOTE: THIS DRAWING IS AN OUTLINE DRAWING OF THE RESPECTIVE DMC PART NUMBER INDICATED. ACTUAL DMC PART NUMBER IS DRAWING NUMBER WITHOUT THE "-ENV" SUFFIX.		CAD P/N K158-ENV	SHEET 1 OF 1
		DWG. NO. K158-ENV	REV. 2
		DANIELS MANUFACTURING CORP. ORLANDO, FLORIDA CAGE 11851	