

REVISIONS				
REV. SYM.	E.C.D. NUMBER	DESCRIPTION	BY DATE	APP'D DATE
2		REDRAWN	AAM 1-26-00	RRR 1-26-00

UNCONTROLLED DOCUMENT

WILL NOT BE UPDATED

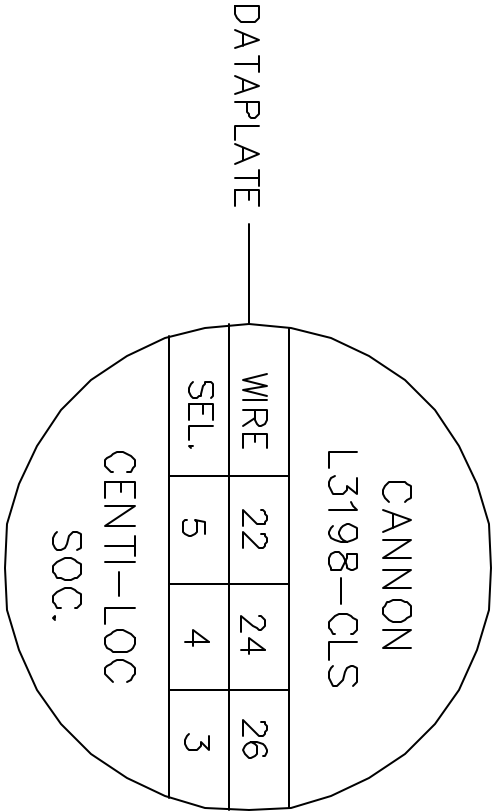
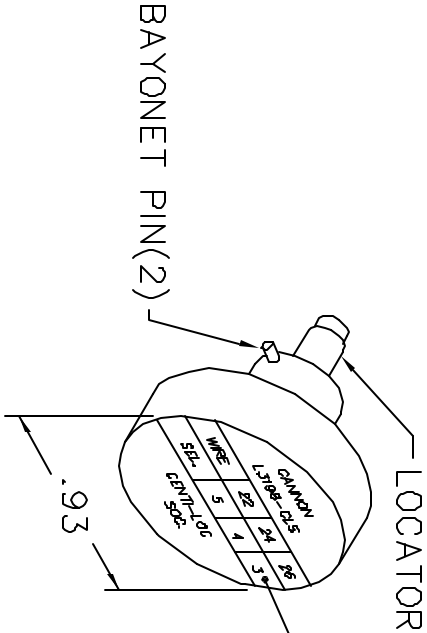
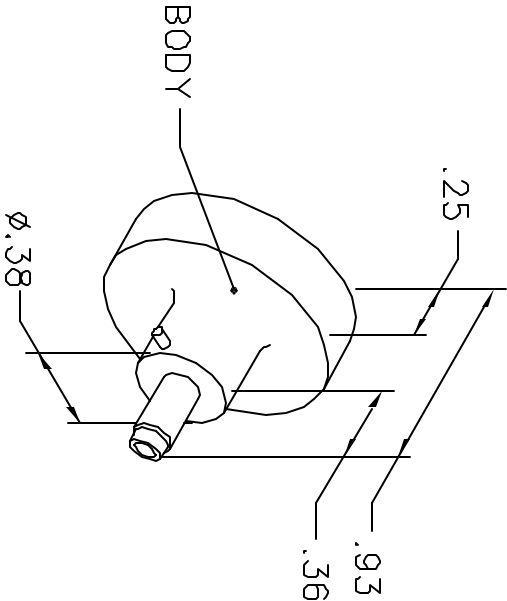

NOTE: FOR USE WITH DANIELS CRIMP TOOLS
ACCOMMODATING "K" SERIES POSITIONERS

LOCATOR	
HOLE DIMENSIONS	ADDITIONAL FEATURES
Ø.062 ▽.305	Ø.030 PIN .29 LONG

RESTRICTED & CONFIDENTIAL

CONFIDENTIAL PROPERTY OF DANIELS MANUFACTURING CORP. NOT TO BE DISCLOSED TO OTHERS, REPRODUCED OR USED FOR ANY OTHER PURPOSE, EXCEPT AS AUTHORIZED IN WRITING BY DANIELS MANUFACTURING. MUST BE RETURNED TO DANIELS MANUFACTURING CORP. ON COMPLETION OF ORDER OR OTHER PURPOSE FOR WHICH LENT.

DO NOT SCALE DRAWING

DRN. DUNG CAO	DATE 9-18-95	<div> <div> </div> <div> DANIELS MANUFACTURING CORP. ORLANDO, FLORIDA CAGE 11851 </div> </div>			
CHKD. DD	DATE 9-18-95				
APP'D.	DATE				
APP'D.	DATE	NOTE: THIS DRAWING IS AN OUTLINE DRAWING OF THE RESPECTIVE DMC PART NUMBER INDICATED. ACTUAL DMC PART NUMBER IS DRAWING NUMBER WITHOUT THE "-ENV" SUFFIX.			
TITLE		WHERE USED: AFMB ENVELOPE DRAWING POSITIONER			
SIZE A	SCALE NTS	CAD P/N K156S-ENV	SHEET 1	OF 1	REV. 2
POSTING	DWG. NO. K156S-ENV				