

REVISIONS				
REV. SYM.	E.C.D. NUMBER	DESCRIPTION	BY DATE	APP'D DATE
1		ORIGINAL RELEASE	TS 5/16/88	DH 5-17-88

**UNCONTROLLED DOCUMENT  
WILL NOT BE UPDATED**

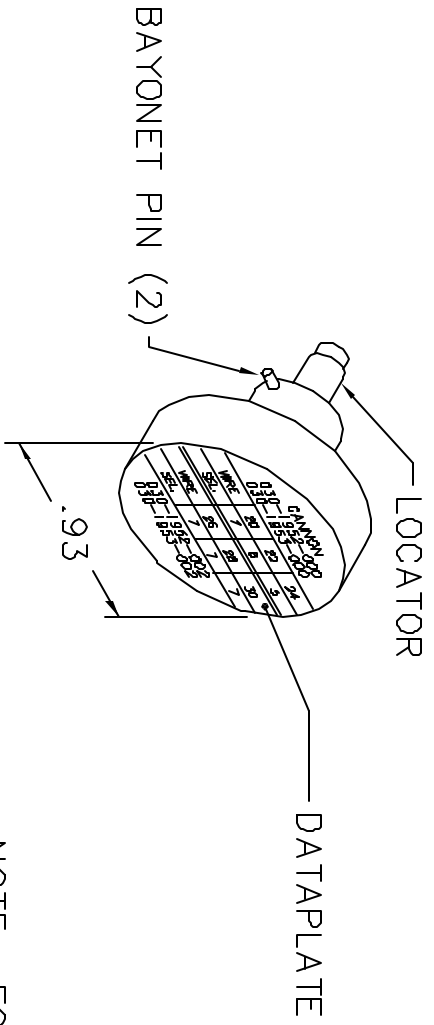
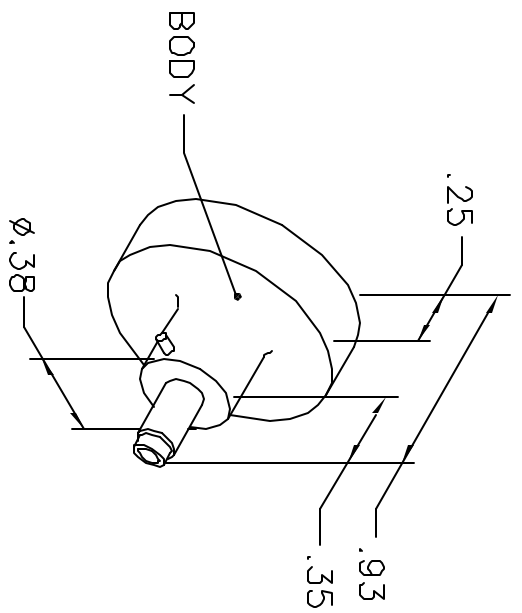

CANNON			
WIRE	20	22	24
SEL.	7	6	5
WIRE	26	28	30
SEL.	7	7	7
030-1952-002			
030-1953-002			

NOTE: FOR USE WITH DANIELS CRIMP TOOLS  
ACCOMMODATING "K" SERIES POSITIONERS

LOCATOR	
HOLE DIMENSIONS	ADDITIONAL FEATURES
Ø.067	└┘ Ø.093
▽.58 MIN.	▽.130

**RESTRICTED & CONFIDENTIAL**

CONFIDENTIAL PROPERTY OF DANIELS MANUFACTURING CORP. NOT TO BE DISCLOSED TO OTHERS, REPRODUCED OR USED FOR ANY OTHER PURPOSE, EXCEPT AS AUTHORIZED IN WRITING BY DANIELS MANUFACTURING. MUST BE RETURNED TO DANIELS MANUFACTURING CORP. ON COMPLETION OF ORDER OR OTHER PURPOSE FOR WHICH LENT.

**DO NOT SCALE DRAWING**

DRN. T. STANFILL	DATE 5/16/88	<b>DMC</b> DANIELS MANUFACTURING CORP. ORLANDO, FLORIDA CAGE 11851	ENVELOPE DRAWING POSITIONER
CHK'D. DH	DATE 5/17/88		
APP'D. AAM	DATE 5/17/88		
APP'D.	DATE	NOTE: THIS DRAWING IS AN OUTLINE DRAWING OF THE RESPECTIVE DMC PART NUMBER INDICATED. ACTUAL DMC PART NUMBER IS DRAWING NUMBER WITHOUT THE "-ENV" SUFFIX.	
WHERE USED: AFM8		CAD P/N	SHEET 1 OF 1
SIZE A	SCALE NTS	DWG. NO. K155-1-ENV	REV. 1
POSTING		K155-1-ENV	