

REVISIONS				
REV. SYM.	E.C.O. NUMBER	DESCRIPTION	BY DATE	APP'D DATE
1		ORIGINAL RELEASE	JWJ 3/19/03	RRR 3/19/03

UNCONTROLLED DOCUMENT
WILL NOT BE UPDATED

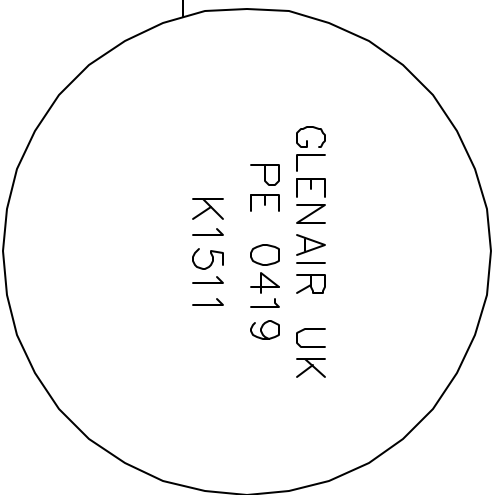
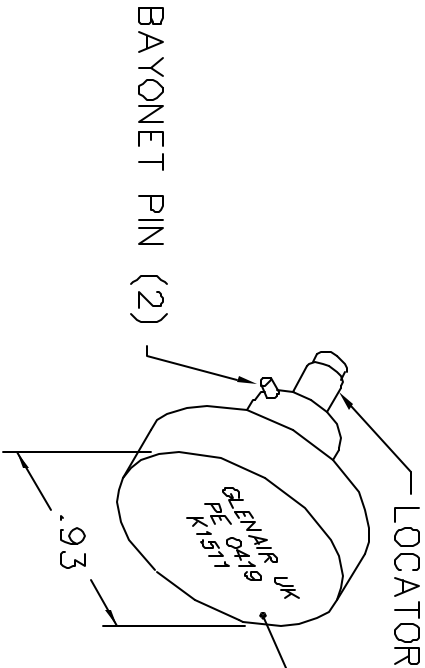
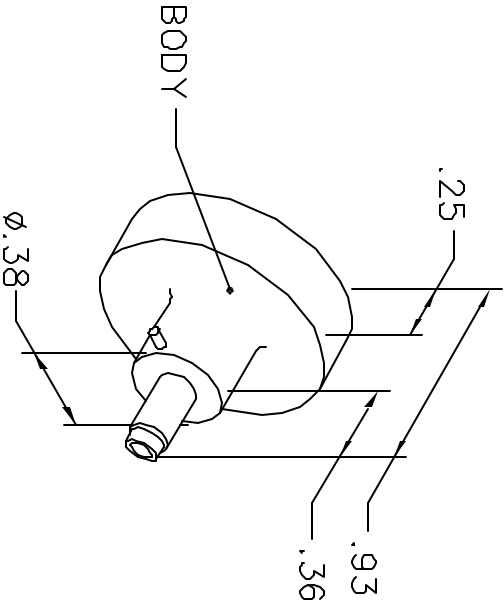

NOTE: FOR USE WITH DANIELS CRIMP TOOLS
ACCOMMODATING "K" SERIES POSITIONERS

LOCATOR	
HOLE DIMENSIONS	ADDITIONAL FEATURES
Ø.025 ▽.58	└┐ Ø.040 ▽.021

RESTRICTED & CONFIDENTIAL		DO NOT SCALE DRAWING	
CONFIDENTIAL PROPERTY OF DANIELS MANUFACTURING CORP. NOT TO BE DISCLOSED TO OTHERS, REPRODUCED OR USED FOR ANY OTHER PURPOSE, EXCEPT AS AUTHORIZED IN WRITING BY DANIELS MANUFACTURING. MUST BE RETURNED TO DANIELS MANUFACTURING CORP. ON COMPLETION OF ORDER OR OTHER PURPOSE FOR WHICH LENT.		THIS DRAWING IS AN OUTLINE DRAWING OF THE RESPECTIVE DMC PART NUMBER INDICATED. ACTUAL DMC PART NUMBER IS DRAWING NUMBER WITHOUT THE "-ENV" SUFFIX.	
DRN. J. JOYCE	DATE 3/19/03	TITLE ENVELOPE DRAWING POSITIONER	
CHKD. RRR	DATE 3/19/03	WHERE USED: AFMB	
APPD.	DATE	SIZE SCALE CAD P/N SHEET OF	
APPD.	DATE	A NTS K1511-ENV 1 1	
DMC PART NUMBER		DWG. NO. K1511-ENV	
REV. 1		REV. 1	

DMC DANIELS MANUFACTURING CORP.
ORLANDO, FLORIDA
CAGE 11851