

REVISIONS				
REV. SYM.	E.C.D. NUMBER	DESCRIPTION	BY DATE	APP'D DATE
1		ORIGINAL RELEASE	JMU 3/27/03	RRR 3/27/03

**UNCONTROLLED DOCUMENT
WILL NOT BE UPDATED**

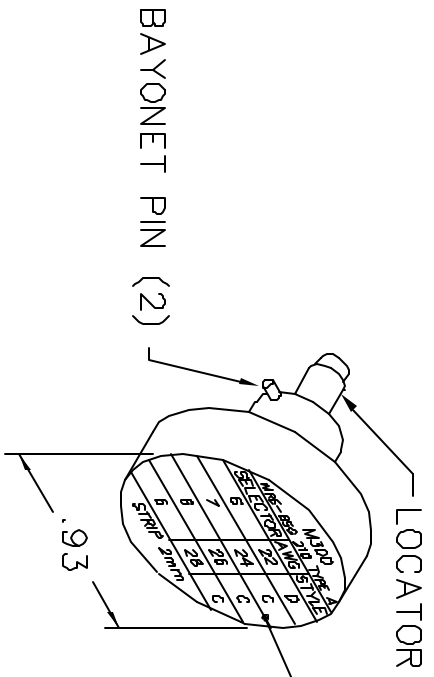
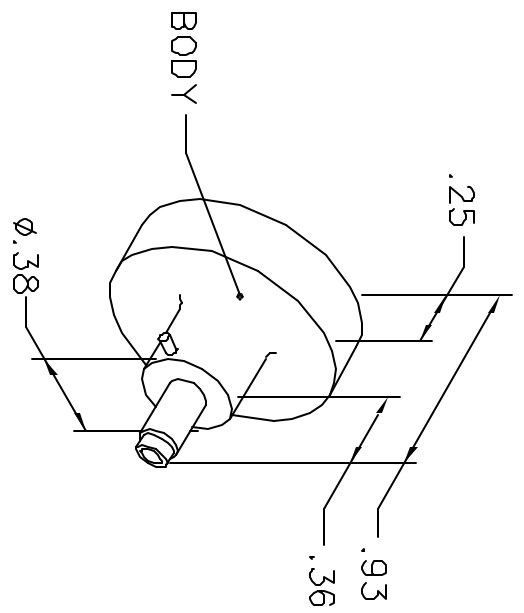

M 300		
WIRE-BSG 210 TYPE A		
SELECTOR	AWG	STYLE
6	22	D
7	24	C
6	26	C
6	28	C
STRIP 2mm		

NOTE: FOR USE WITH DANIELS CRIMP TOOL, AFM8.

LOCATOR	
HOLE DIMENSIONS	ADDITIONAL FEATURES
∅.032 ∓.195	L ∅.065 ∓.185

RESTRICTED & CONFIDENTIAL

CONFIDENTIAL PROPERTY OF DANIELS MANUFACTURING CORP. NOT TO BE DISCLOSED TO OTHERS, REPRODUCED OR USED FOR ANY OTHER PURPOSE, EXCEPT AS AUTHORIZED IN WRITING BY DANIELS MANUFACTURING. MUST BE RETURNED TO DANIELS MANUFACTURING CORP. ON COMPLETION OF ORDER OR OTHER PURPOSE FOR WHICH LENT.

DO NOT SCALE DRAWING

DRN. J. JOYCE	DATE 3/27/03	DANIELS MANUFACTURING CORP. ORLANDO, FLORIDA CAGE 11851			
CHKD. RRR	DATE 3/27/03				
APP'D.	DATE	TITLE ENVELOPE DRAWING POSITIONER			
APP'D.	DATE				
NOTE: THIS DRAWING IS AN OUTLINE DRAWING OF THE RESPECTIVE DMC PART NUMBER INDICATED. ACTUAL DMC PART NUMBER IS DRAWING NUMBER WITHOUT THE "-ENV" SUFFIX.		WHERE USED:	CAD P/N	SHEET	OF
		SIZE A	K1167-ENV	1	1
		POSTING	DWG. NO. K1167-ENV	REV.	1