

REVISIONS				
REV. SYM.	E.C.O. NUMBER	DESCRIPTION	BY DATE	APP'D DATE
1		ORIGINAL RELEASE	JWJ 5/5/04	RRR 5/5/04

UNCONTROLLED DOCUMENT
WILL NOT BE UPDATED

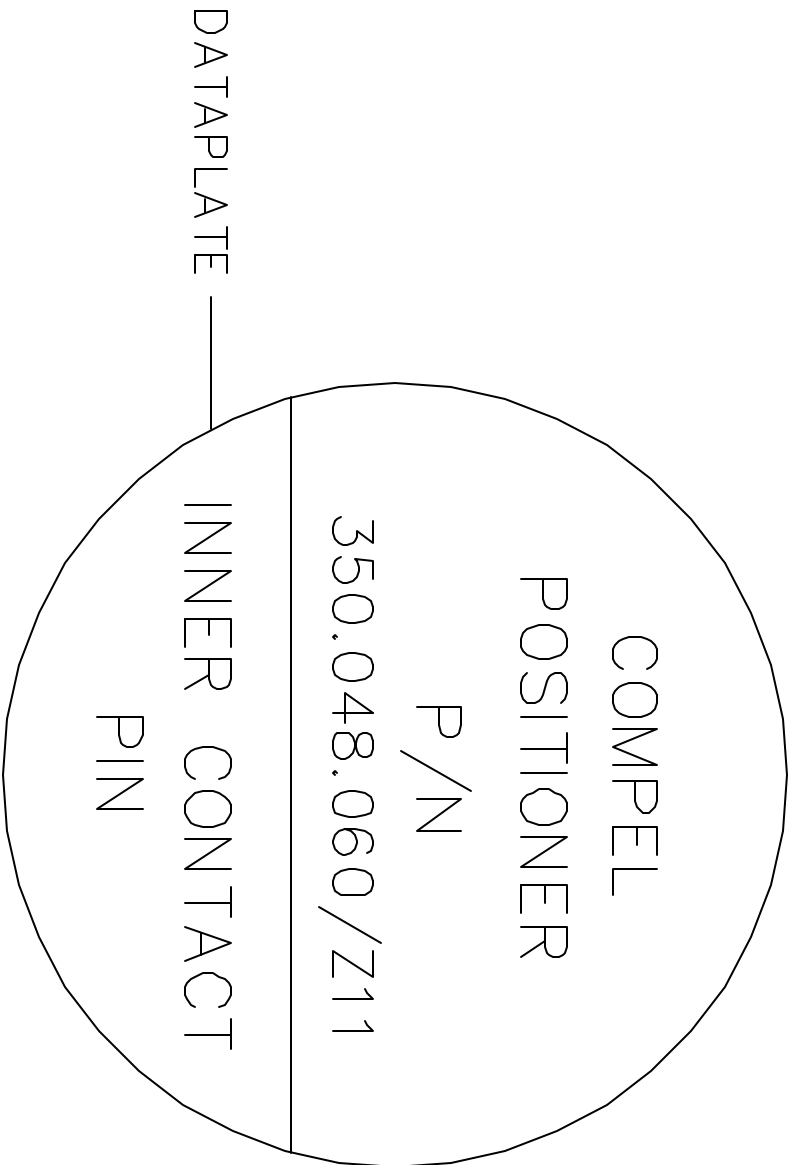
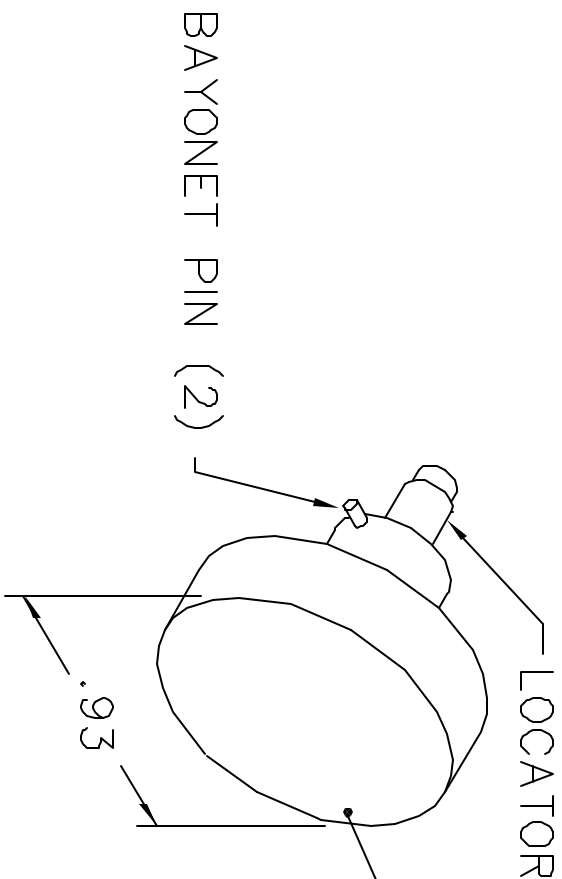
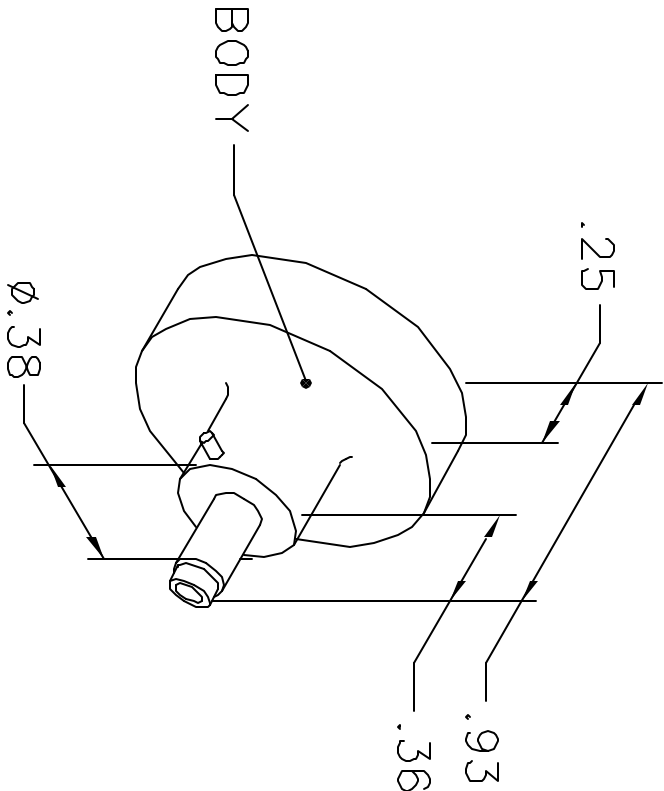

NOTE: FOR USE WITH DANIELS CRIMP TOOL, AFM8.

LOCATOR	
HOLE DIMENSIONS	ADDITIONAL FEATURES
Ø.063 ▽.58 MIN.	└┐ Ø.073 ▽.050

RESTRICTED & CONFIDENTIAL		DRN. J. JOYCE DATE 5/5/04		TITLE	
CONFIDENTIAL PROPERTY OF DANIELS MANUFACTURING CORP. NOT TO BE DISCLOSED TO OTHERS, REPRODUCED OR USED FOR ANY OTHER PURPOSE, EXCEPT AS AUTHORIZED IN WRITING BY DANIELS MANUFACTURING. MUST BE RETURNED TO DANIELS MANUFACTURING CORP. ON COMPLETION OF ORDER OR OTHER PURPOSE FOR WHICH LENT.		CHK'D. RRR	DATE 5/5/04	DANIELS MANUFACTURING CORP. ORLANDO, FLORIDA CAGE 11851	
		APP'D.	DATE		
		APP'D.	DATE		
DO NOT SCALE DRAWING		NOTE: THIS DRAWING IS AN OUTLINE DRAWING OF THE RESPECTIVE DMC PART NUMBER INDICATED. ACTUAL DMC PART NUMBER IS DRAWING NUMBER WITHOUT THE "-ENV" SUFFIX.		WHERE USED: POSITIONER ENVELOPE DRAWING	
		SIZE A	SCALE NTS	CAD P/N K1166-1-ENV	SHEET 1 OF 1
		POSTING		DWG. NO. K1166-1-ENV	REV. 1