

REVISIONS				
REV. SYM.	E.C.D. NUMBER	DESCRIPTION	BY DATE	APP'D DATE
1		ORIGINAL RELEASE	JMJ 8/4/04	RRR 8/4/04

**UNCONTROLLED DOCUMENT  
WILL NOT BE UPDATED**

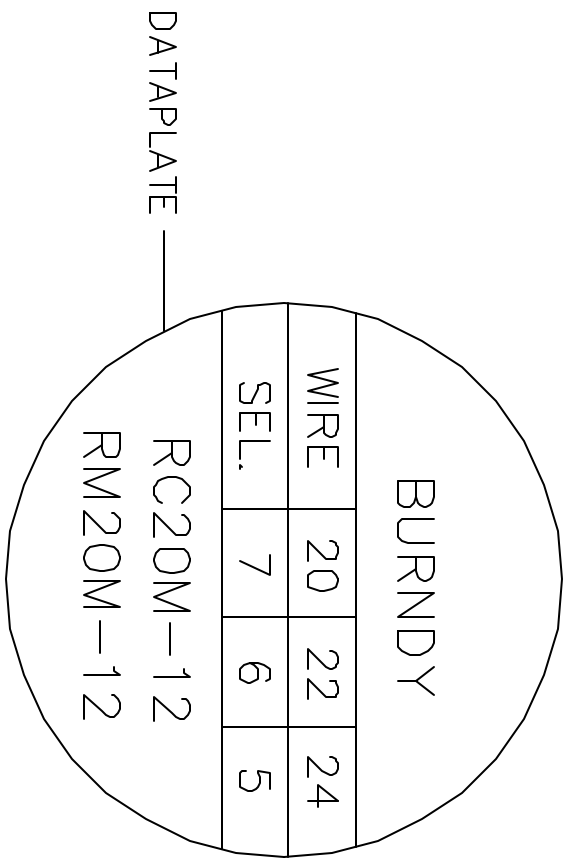
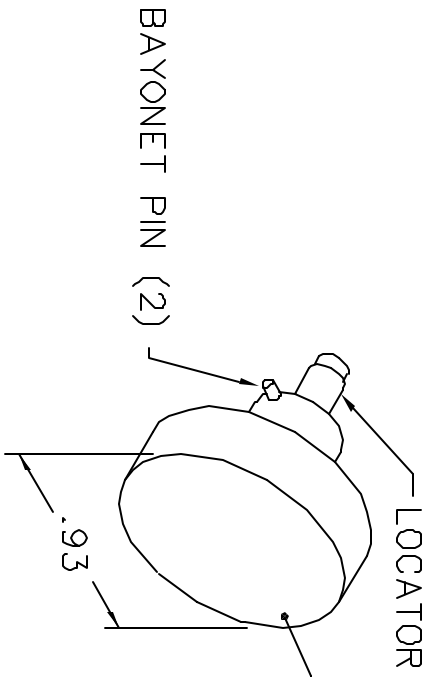
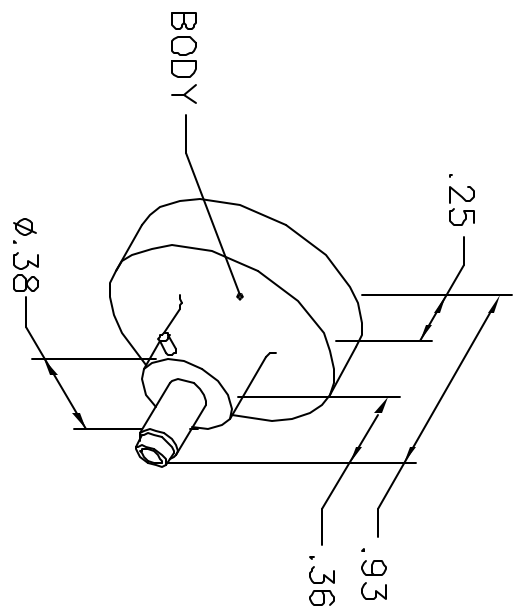

NOTE: FOR USE WITH DANIELS CRIMP TOOL, AFM8.

LOCATOR	
HOLE DIMENSIONS	ADDITIONAL FEATURES
∅.093 ∇.740	└┐∅.136 ∇.427

**RESTRICTED & CONFIDENTIAL**

CONFIDENTIAL PROPERTY OF DANIELS MANUFACTURING CORP. NOT TO BE DISCLOSED TO OTHERS, REPRODUCED OR USED FOR ANY OTHER PURPOSE, EXCEPT AS AUTHORIZED IN WRITING BY DANIELS MANUFACTURING. MUST BE RETURNED TO DANIELS MANUFACTURING CORP. ON COMPLETION OF ORDER OR OTHER PURPOSE FOR WHICH LENT.

DO NOT SCALE DRAWING

DRN.	J. JOYCE	DATE	8/4/04
CHK'D.	RRR	DATE	8/4/04
APP'D.		DATE	
APP'D.		DATE	

<p>NOTE: THIS DRAWING IS AN OUTLINE DRAWING OF THE RESPECTIVE DMC PART NUMBER INDICATED. ACTUAL DMC PART NUMBER IS DRAWING NUMBER WITHOUT THE "-ENV" SUFFIX.</p>		<p>WHERE USED:</p>	
<p>TITLE POSITIONER ENVELOPE DRAWING</p>		CAD P/N	K110-ENV
SIZE	A	SCALE	NTS
POSTING		DWG. NO.	K110-ENV
SHEET	1	OF	1
REV.	1		



DANIELS MANUFACTURING CORP.  
ORLANDO, FLORIDA  
CAGE 11851