

**UNCONTROLLED DOCUMENT  
WILL NOT BE UPDATED**

REVISIONS				
REV. SYM.	E.C.O. NUMBER	DESCRIPTION	BY DATE	APP'D DATE
1		ORIGINAL RELEASE	DH 12/4/87	JS 12/87

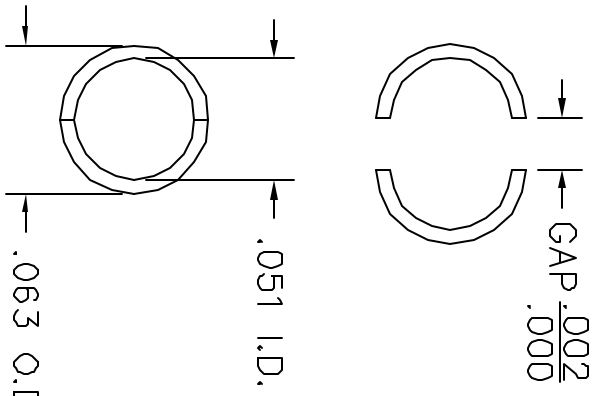

END VIEW

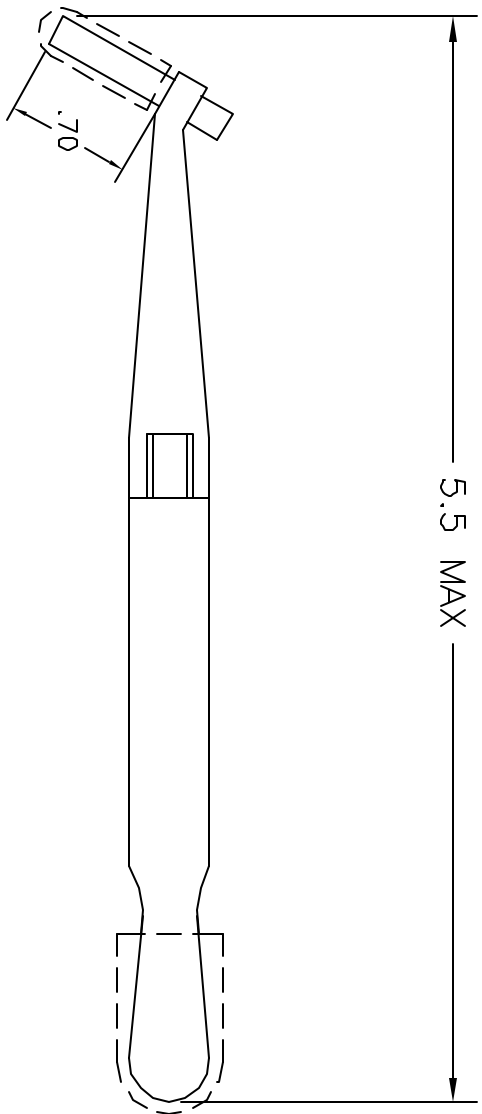

<p><b>RESTRICTED &amp; CONFIDENTIAL</b></p> <p>CONFIDENTIAL PROPERTY OF DANIELS MANUFACTURING CORP. NOT TO BE DISCLOSED TO OTHERS, REPRODUCED OR USED FOR ANY OTHER PURPOSE EXCEPT AS AUTHORIZED IN WRITING BY DANIELS MANUFACTURING. MUST BE RETURNED TO DANIELS MANUFACTURING CORP. ON COMPLETION OF ORDER OR OTHER PURPOSES FOR WHICH SENT.</p>		MATERIAL		HEAT TREAT		FINISH					
		ITEM		PART NO.		QTY.		DESCRIPTION/REMARKS			
DRN.	DH	DATE	12/4/87	CHKT'D.	JS	DATE	12/4/87	<p><b>DMC</b> DANIELS MANUFACTURING CORP. ORLANDO, FLORIDA CAGE 11851</p>			
APP'D.	AAM	DATE	12/4/87	APP'D.		DATE					
<p>NOTE: THIS DRAWING IS AN OUTLINE DRAWING OF THE RESPECTIVE DMC PART NUMBER INDICATED. ACTUAL DMC PART NUMBER IS DRAWING NUMBER WITHOUT THE "-ENV" SUFFIX.</p>				TITLE		WHERE USED:					
				REMOVAL TOOL #22ML ENVELOPE DRAWING							
DO NOT SCALE DRAWING		SIZE	A	SCALE	NTS	CAD P/N	DRK95-22ML-ENV	SHEET	1	OF	1
		POSTING		DWG. NO.	DRK95-22ML-ENV			REV.	1		