

REVISIONS			
REV. SWA	E.C.O. NUMBER	DESCRIPTION	BY DATE
1		ORIGINAL RELEASE	LLW 8/19/91 PD 8/20/91

MARKED WITH CONTACT SIZE

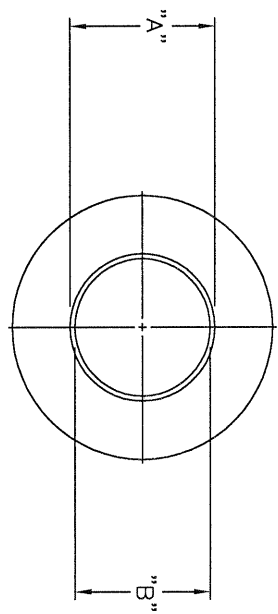
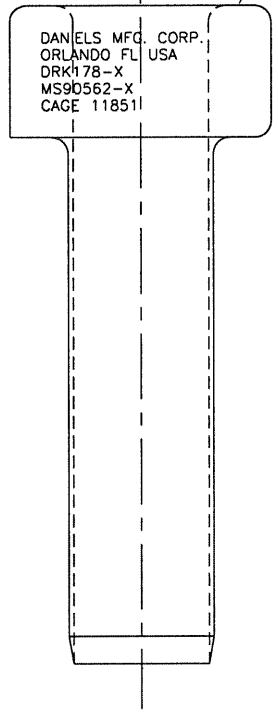

DRK178-1	MS90562-1	4/0	.790	.753
DRK178-2	MS90562-2	2/0	.696	.659
DRK178-3	MS90562-3	1/0	.558	.521
DRK178-4	MS90562-4	2	.462	.425
DRK178-5	MS90562-5	4	.376	.339
DRK178-6	MS90562-6	6	.354	.317
DANIELS P/N	MIL SPEC P/N	CONTACT SIZE	Ø"A"	Ø"B"

RESTRICTED & CONFIDENTIAL		MATERIAL		ITEM		PART NO.		QTY.		DESCRIPTION/REMARKS	
CONFIDENTIAL PROPERTY OF DANIELS MANUFACTURING CORP. NOT TO BE DISCLOSED TO OTHERS, REPRODUCED OR USED FOR ANY OTHER PURPOSE, EXCEPT AS AUTHORIZED IN WRITING BY DANIELS MANUFACTURING CORP. ORLANDO FLORIDA. THIS DRAWING IS AN OUTLINE DRAWING OF THE RESPECTIVE INDICATED PART NUMBER. THIS DRAWING IS AN OUTLINE DRAWING OF THE RESPECTIVE INDICATED PART NUMBER. THIS DRAWING IS AN OUTLINE DRAWING OF THE RESPECTIVE INDICATED PART NUMBER WITHOUT THE "-ENV" SUFFIX.		HEAT TREAT		DRN.	LLW	DATE	DATE	TITLE		DANIELS MANUFACTURING CORP. ORLANDO, FLORIDA CAGE 11851	
		FINISH		CHK'D.	PD	DATE	DATE	WHERE USED:		REMOVAL TOOL (MS90562-X)	
DO NOT SCALE DRAWING		FINISH		APP'D.	AAM	DATE	DATE	ENVELOPE DRAWING		SHEET 1 OF 1	
				APP'D.		DATE	DATE	DRK178-X-ENV		REV 1	