

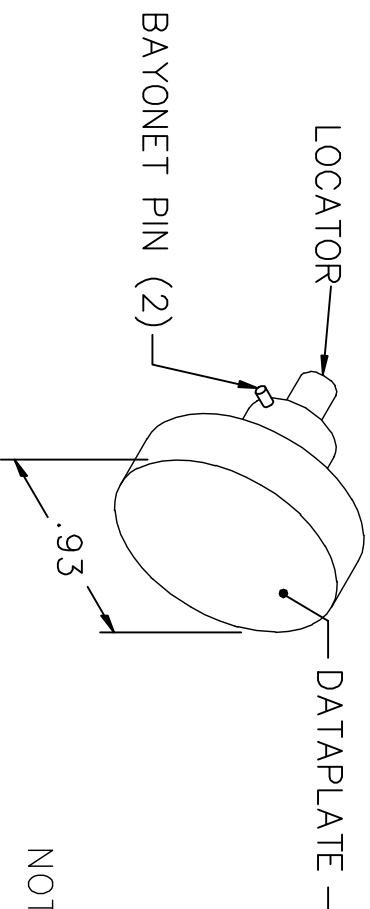

REVISIONS				
REV. SYM.	E.C.O. NUMBER	DESCRIPTION	BY DATE	APP'D DATE
2	21444	DATAPLATE CHANGE	JD 9-22-09	

**UNCONTROLLED DOCUMENT  
WILL NOT BE UPDATED**

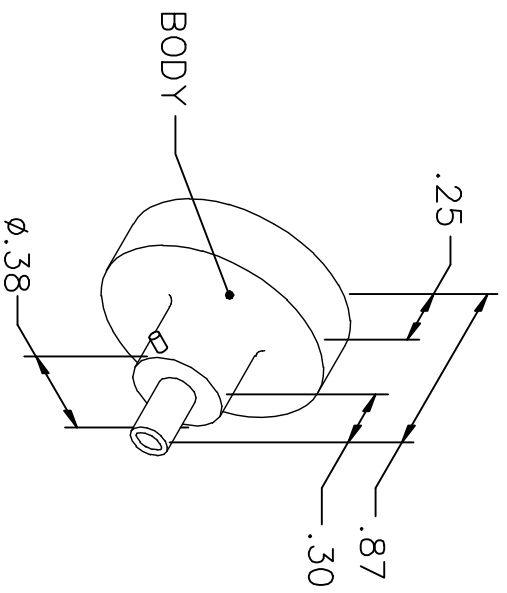

 Jupiter  
 PART NO: JBX 1 OUT LP13

WIRE SIZE	18	20	22
POS.	8	7	7

USE WITH CONTACT NO:  
 JBX 1 CT MC13  
 Ø1.3mm PIN, SIZE 1

NOTE: FOR USE WITH DANIELS CRIMP TOOLS  
ACCOMMODATING "86" SERIES POSITIONERS

LOCATOR	
HOLE DIMENSIONS	ADDITIONAL FEATURES
∅.053 ∇.464	∅.114 ∇.28

**RESTRICTED & CONFIDENTIAL**

CONFIDENTIAL PROPERTY OF DANIELS MANUFACTURING CORP. NOT TO BE DISCLOSED TO OTHERS, REPRODUCED OR USED FOR ANY OTHER PURPOSE, EXCEPT AS AUTHORIZED IN WRITING BY DANIELS MANUFACTURING. MUST BE RETURNED TO DANIELS MANUFACTURING CORP. ON COMPLETION OF ORDER OR OTHER PURPOSE FOR WHICH LENT.

DO NOT SCALE DRAWING

ITEM	PART NO.	QTY.	DESCRIPTION/REMARKS
DRN. E. DIAZ	DATE 6-29-94		
CHK'D. DE	DATE 6-94		
APP'D.	DATE		
APP'D.	DATE		

NOTE:  
THIS DRAWING IS AN OUTLINE DRAWING OF THE RESPECTIVE DMC PART NUMBER INDICATED. ACTUAL DMC PART NUMBER IS DRAWING NUMBER WITHOUT THE "-ENV" SUFFIX.

 DANIELS MANUFACTURING CORP.  
 ORLANDO, FLORIDA  
 CAGE 11851

TITLE  
 POSITIONER  
 ENVELOPE DRAWING

WHERE USED:

SIZE	SCALE	CAD P/N	SHEET	OF
A	NTS	86-200-ENV	1	1
POSTING		DWG. NO. 86-200-ENV		REV. 2